

K-Lock Nut & External Lockwasher

Thread Type: Metric - Coarse

Thread Direction: Right Hand

Material: Carbon Steel

Class Grade: Low Tensile Class 5

Finish: Zinc Plated

Corrosion Protection Level: Moderate

Standard: DIN 934K

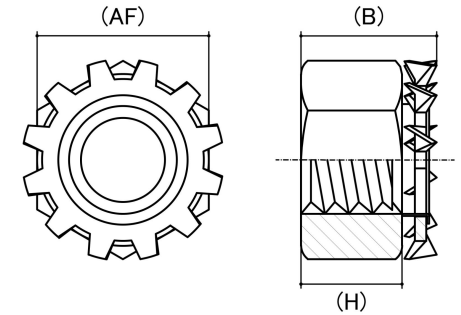

*CAD drawings shown for graphic representation only.**

| Size | Thread Pitch (mm) | Thread Type | Overall Nut Height (B) (mm) | | Across Flats (AF) (mm) | | Spanner Size (AF) (mm) | sku (qfind) |
|------|-------------------|-------------|-----------------------------|------|------------------------|-------|------------------------|-------------|
| | | | Min | Max | Min | Max | | |
| M5 | 0.80 | Coarse | 4.80 | 5.10 | 7.78 | 8.00 | 8 | 41KL5 |
| M6 | 1.00 | Coarse | 4.90 | 5.20 | 9.78 | 10.00 | 10 | 41KL6 |

Disclaimer:

Dimensional data and technical information was obtained from publically available sources and not acquired through standard agencies. It has been completed and compiled for reference purposes only; where discrepancies are found they are subject to change without notice. Bolt & Nut Australia makes no warranties or representations regarding the accuracy and validity of the compiled information and data. Contact the relevant standard authorities for accurate and detailed information.

* CAD drawings may not reflect diameter, thread length or overall length.

© Bolt & Nut Australia Pty Ltd. All rights reserved.

Version: 18 Mar 2024